

## WHAT'S IN THE BOX

---

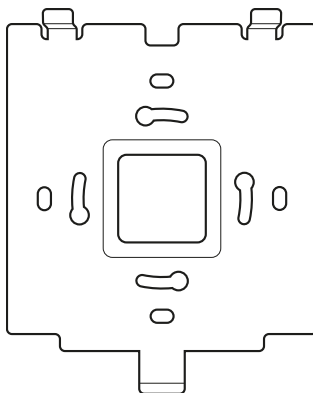

## IMPORTANT

- Download the latest CP100 Owner's manual from the Manuals/Downloads tab of [www.bluesoundprofessional.com/product/CP100](http://www.bluesoundprofessional.com/product/CP100)
- Visit [support.bluesound.com](http://support.bluesound.com) for further information and assistance about getting the most out of your CP100.

# INSTALL

---

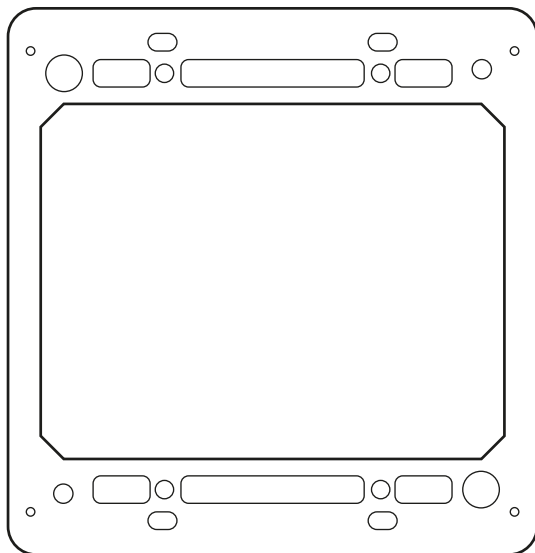
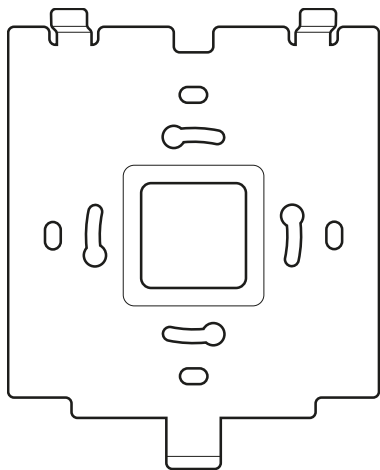

Use compatible screws to install bracket to an in-wall low voltage box (not supplied).

# CONNECT AND POWER UP

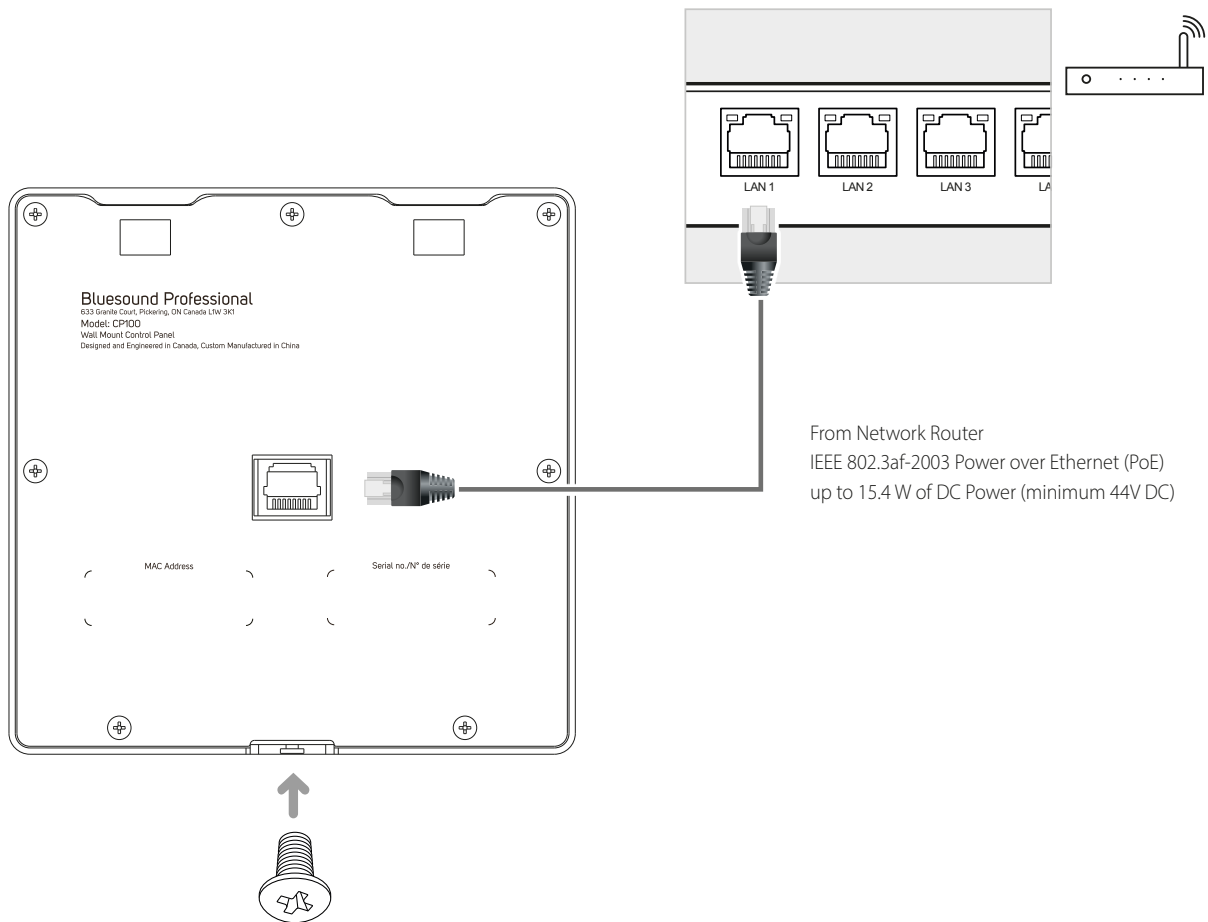

Slot-in Control Panel to the bracket, secure with screw and connect Ethernet cable (not supplied).

# DOWNLOAD

---

## BluOS INTEGRATION UTILITY APP

- 1 BluOS Integration Utility App for Windows or macOS is available for download from [www.bluesoundprofessional.com/downloads](http://www.bluesoundprofessional.com/downloads)
- 2 Scroll to the bottom of the page to download corresponding App.
- 3 Launch BluOS Integration Utility App.
- 4 Refer to CP100 owner's manual on how to configure the Control Panel.

©2024 BLUESOUND PROFESSIONAL, A DIVISION OF LENBROOK INDUSTRIES LIMITED

All rights reserved. Bluesound and Bluesound logo are trademarks of Bluesound Professional, a division of Lenbrook Industries Limited.  
No part of this publication may be reproduced, stored or transmitted in any form without the written permission of Bluesound Professional.  
CP100-QS-EN-V08 - MAR 2024